

**ASSEMBLY NOTES:**

1. USE PERMANENT THREADLOCKER (LOCTITE 262 OR EQUIVALENT) ON ITEMS 3, 5 AND 6.
2. SILVER SOLDER ASSEMBLED JOINTS AND POLISH SMOOTH.
3. DURING FINAL ASSEMBLY: APPLY THIN LAYER OF (LOCTITE 404) AFTER O-RINGS ARE INSTALLED AND JUST BEFORE THE BAR.

**BILL OF MATERIAL**

ITEM	PT/ASSY	DESCRIPTION	QTY.	DWG.NO.
1	454B	MOUNTING FLANGE	2	HTL-049
2	4500	ROSETTE	2	45A-003
3	4540SP	HOTEL SHELF POST	2	HTL-050
4	4540LPL	HOTEL SHELF POST LEFT (LONG)	1	HTL-052
5	4550F	POST FLANGE	6	45A-005
6	4540-43ADP	THREAD EXTENSION	2	HTL-051
7	4543DT	DOWN TUBE	2	HTL-054
8	4540	TOWEL BAR BALL END	2	HTL-055
9	4540LPR	HOTEL SHELF POST RIGHT (LONG)	1	HTL-052
10	SM5-5S	M5 x5 STAINLESS STEEL SET SCREW	2	-
11	454320	HOTEL SHELF TUBES	1	HTL-054
12	454020	SIDE TUBE	2	HTL-053
13	45408	CROSS TUBE	9	HTL-054
14	10_1-5_PFS	No. 10 x 1-1/2" P H S.S. SELF TAPPING	6	-
15	GCA	NO. 8 -10 WALL ANCHOR PLASTIC	6	-
16	M2_5HK	2.5MM ALLOY STEEL HEX KEY	1	-
17	SSPM	DRYWALL ANCHOR	6	-
18	RM16-1	16mm x 1mm BUNA-N- O-RING	6	-
19	4540LP	HOTEL SHELF POST (LONG)	2	HTL-052

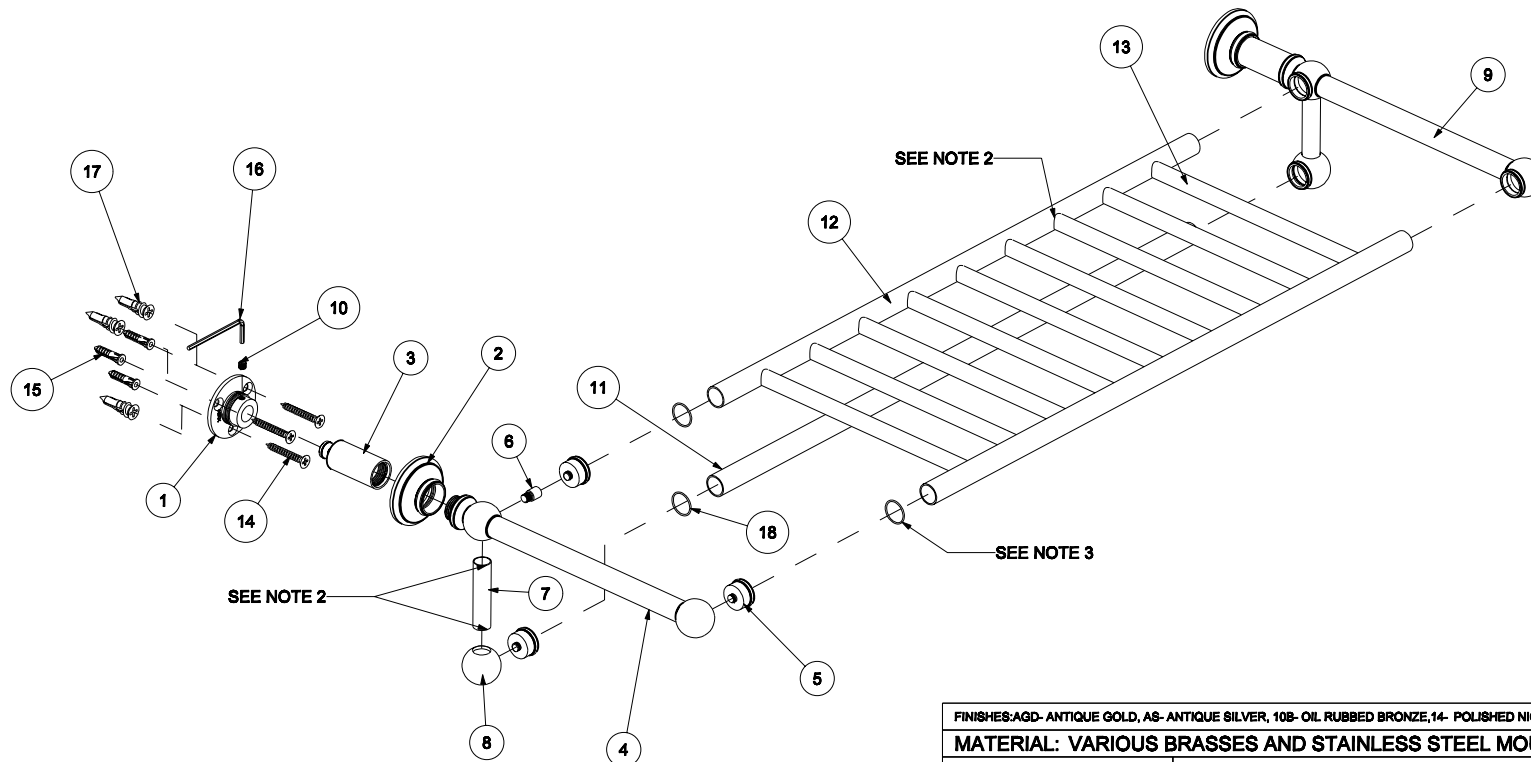

FINISHES:AGD- ANTIQUE GOLD, AS- ANTIQUE SILVER, 10B- OIL RUBBED BRONZE,14- POLISHED NICKEL, 15- SATIN NICKEL, 26 POLISHED CHROME			
MATERIAL: VARIOUS BRASSES AND STAINLESS STEEL MOUNTING HARDWARE			
PART NO.	4543-20	20" COLUMNAR HOTEL SHELF W/ TOWEL BAR	
DATE:11.27.06	REV.DATE:4.03.07	REV.B	SCALE 3:16
			COLUMNAR

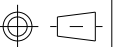

**GINGER**  
**DWG.NO.**  
**4543-20**

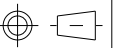
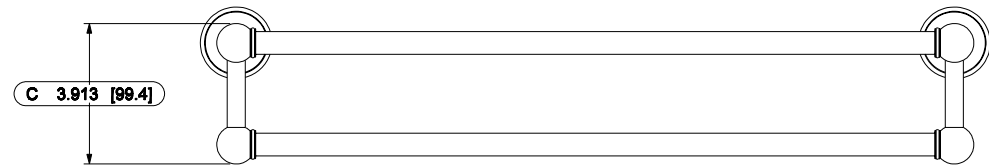
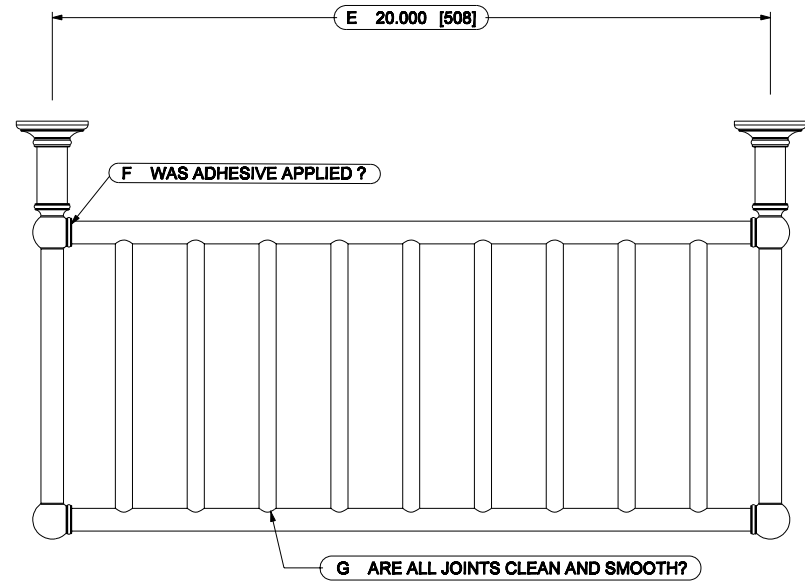
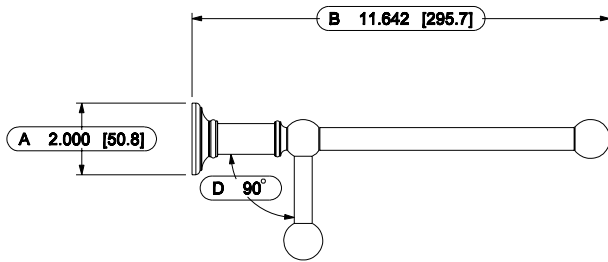

FINISHES: A0- ANTIQUE GOLD, A8- ANTIQUE SILVER 3- POLISHED BRASS, 10B- OIL RUBBED BRONZE, 14- POLISHED NICKEL, 15- SATIN NICKEL, 15A- ANTIQUE NICKEL, 26 POLISHED CHROME				
MATERIAL: VARIOUS BRASSES AND STAINLESS STEEL MOUNTING HARDWARE				
PART NO.	4543-20	20" COLUMNAR HOTEL SHELF W/ TOWEL BAR		
DATE: 11.27.06	REV. DATE: 4.03.07	REV. B	SCALE 3:16	COLUMNAR

GINGER  
DWG. NO.  
4543-20

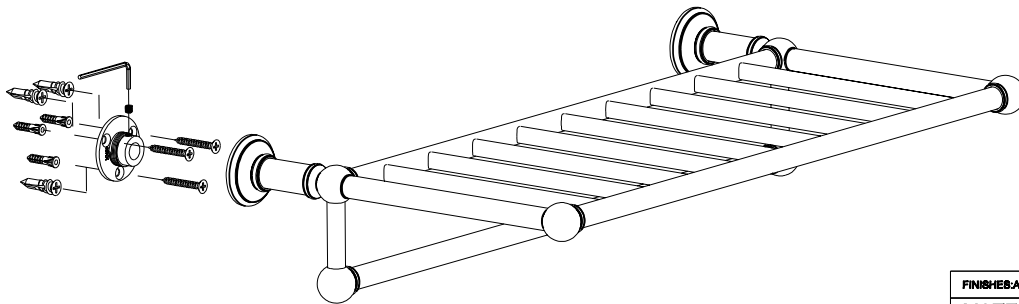
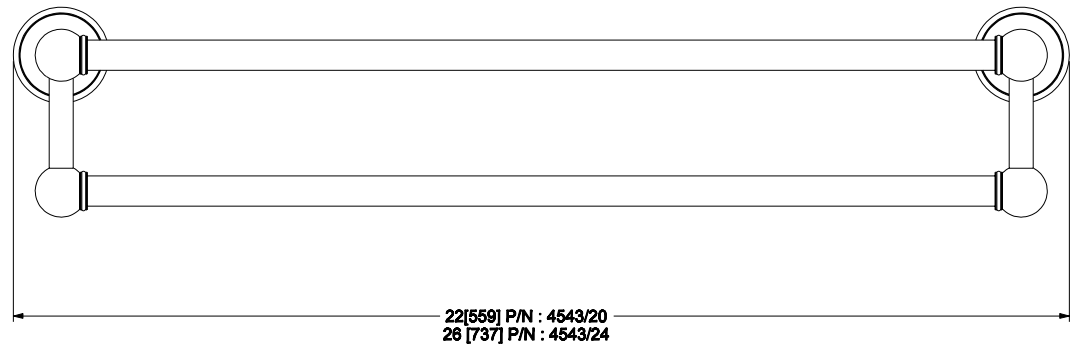
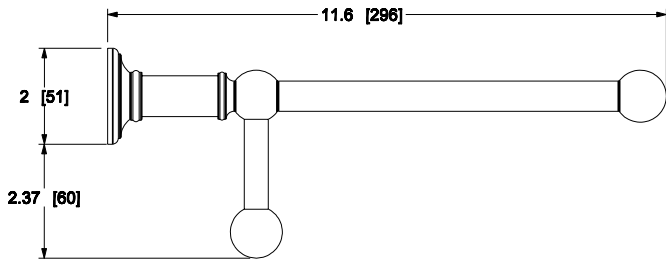
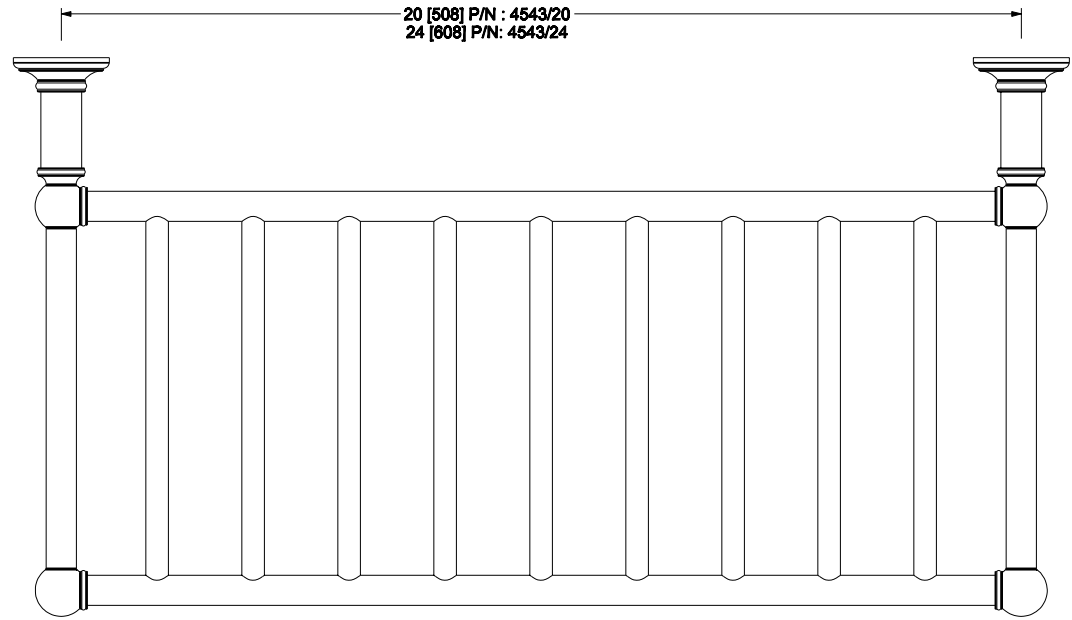

FINISHES: 01- ANTIQUE GOLD, 02- ANTIQUE SILVER, 03- OIL RUBBED BRONZE, 04- POLISHED NICKEL, 05- SATIN NICKEL, 06 POLISHED CHROME		UNIT: INCH [MM]
MATERIAL: VARIOUS BRASSES, STAINLESS STEEL MOUNTING HARDWARE		WEIGHT: 4LBS. 7 OZ. [ 2.0 KG.]
PART NO. 4543/20 - 4543/24	<b>HOTEL SHELF</b>	
DATE: 5.07.07	REV. DATE:	SCALE 1:4
		COLUMNAR

**GINGER**  
DWG. NO.  
PD-4543

